

# ACCESS LINK WITH OPTIONAL ACTIVATE DAILY OPERATION INSTRUCTIONS

PLEASE FOLLOW ACCESS LINK SET UP INSTRUCTIONS ON OPPOSITE PAGE.

## ENSURE THE SYSTEM IS POWERED ON

1. Locate the 24V power supply and power cable and connect the AC power cord into the DC power supply. Insert the DC connector into the DC Power jack on the back and plug the AC power cord into an electrical outlet.
2. Press the Activate Station power button to power on the Access Link. When powered on, the blue LED will glow.

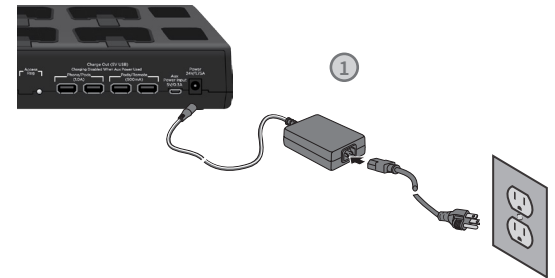

## USING THE FLEXMIKE

3. Remove microphone from charger and place the microphone around your neck. Ensure the top of the microphone is at the collarbone.
4. Press the power/mute button. The teacher status will turn blue, indicating the microphone is active.
5. Microphone volume may be adjusted at the microphone by using the Up/Down buttons on the side of the Flexmike. It may also be adjusted by using the Microphone volume buttons on the front of the Activate.
6. For recording video, audio and images, ensure your mobile device is paired with Activate. If not paired, refer to the Mobile Device Pairing Quickstart guide.

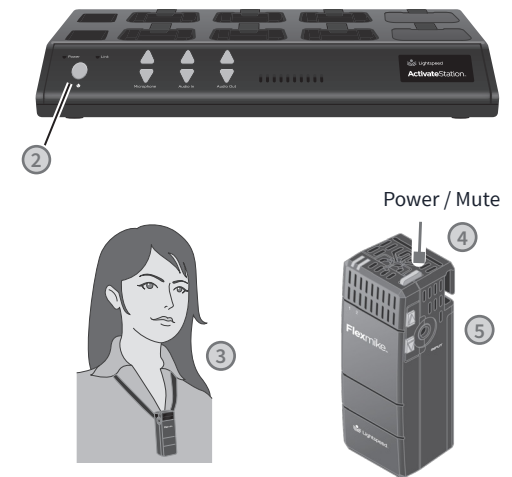

## USING A WIRELESS AUDIO LINK

7. Plug your external audio equipment (for example, laptop), into one of the input jacks on the back of the Activate labeled "Aux Input" using a 3.5mm patch cable.
8. Adjust volume at the audio source. If necessary, further volume adjustment may be made using the Audio In volume buttons on the front of the Activate.

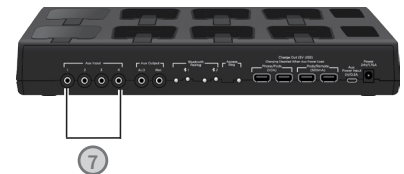

## CHARGE FLEXMIKE NIGHTLY

9. Place the Flexmike into the charger. The power button light will glow red and the Mic status light will glow blue. When Flexmike is fully charged, the power button light on the mic will change to green.

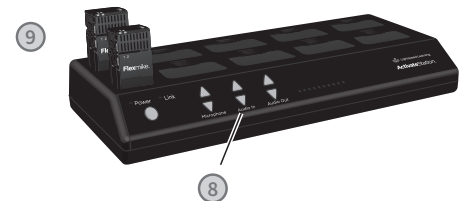

# ACCESS LINK SET UP AND DAILY OPERATION INSTRUCTIONS



## DETERMINE SET-UP LOCATION AND PLUG IN POWER SUPPLY

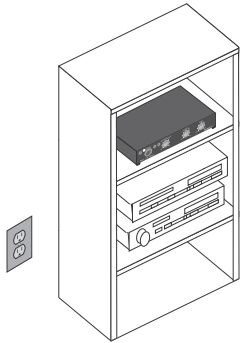

1. The Access Link is generally located near the amplifier.
2. Plug one end of the included 3.5mm cable into the AUDIO OUTPUT connection on the Access Link. Plug the other end into an audio input connection on the amplifier.
3. Use the Cat5e cable to connect a Lightspeed CAT 885 to the Access Link to provide power and send audio through the system. When connecting Access Link to a different amplifier, plug the micro USB end of the power cable into the USB port on the back of the Access Link. Plug the other end of the cable into the USB1 power adaptor, then plug into an outlet.

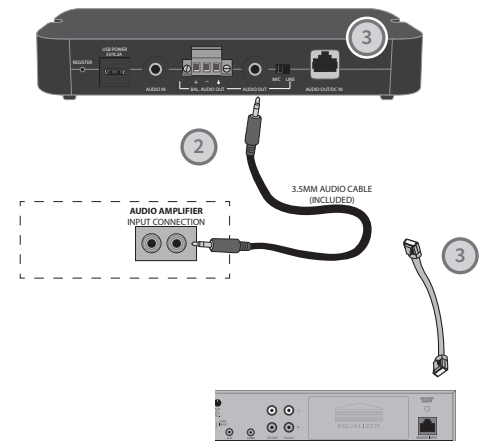

## ENSURE THE SYSTEM IS POWERED ON

4. Press the Access Link power button to power on.
5. When powered on, the blue LED will glow.
6. Remove microphone from charger and place the microphone around your neck. Ensure the top of the microphone is at the collarbone.
7. Press the power/mute button. The teacher status will turn blue, indicating the microphone is active.
8. Microphone volume may be adjusted at the microphone by using the UP/DOWN buttons on the side of the Flexmike. It may also be adjusted by using the MICROPHONE volume knob on the front of the Access Link or the optional Media Connector.

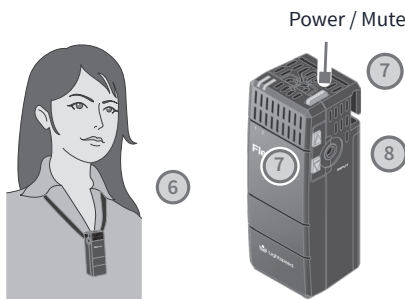
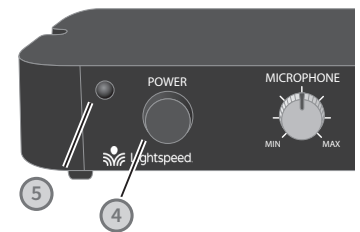

## CHARGE FLEXMIKE NIGHTLY

9. Place the Flexmike into the cradle charger. The power button light will glow red and the Mic status light will glow blue. When Flexmike is fully charged, the power button light on the mic will change to green.



## USING A WIRELESS AUDIO LINK

10. Plug your external audio equipment (for example, laptop), into the Audio In 3.5mm jack on the back of the Access Link, or into one of the input jacks on the back of the optional Media Connector labeled "Audio In", using a 3.5mm patch cable.
11. Adjust volume at the audio source. If necessary, further volume adjustment may be made using the Audio In volume knob on the front of the Access Link or the Media Connector.

