

# T25 Instructional Audio System

## CONNECT POWER TO T25

- 1 Connect the AC power cord into the DC power supply. Insert the connector into the T25 and plug the power cord into an electrical outlet.
- 2 The T25 will automatically power on and the white power light will glow.

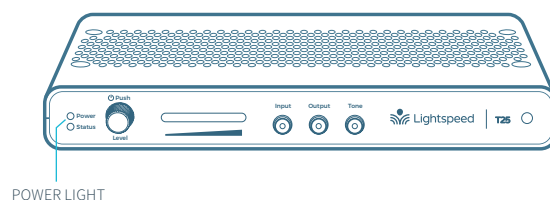

## USING THE CLEARMIKE

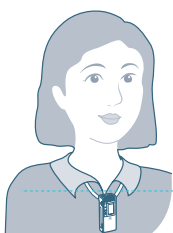

Remove microphone from charger. Press the mute button to unmute, hold near your mouth and begin speaking.

ALIGN WITH COLLARBONE

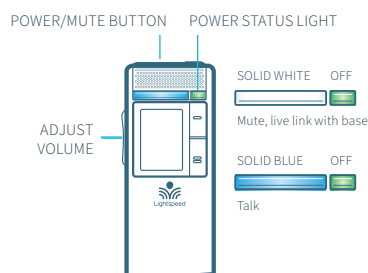

## USING THE SHAREMIKE



Remove microphone from charger and press the mute button to begin speaking.

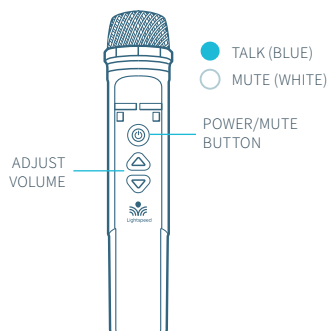

## CHARGE MICROPHONES NIGHTLY

- Place the microphones into the cradle charger.
- The Power Status light will glow red when it is charging.
- It takes about 5-6 hours to fully charge the battery.
- When charging is complete, the Power Status light will glow green.

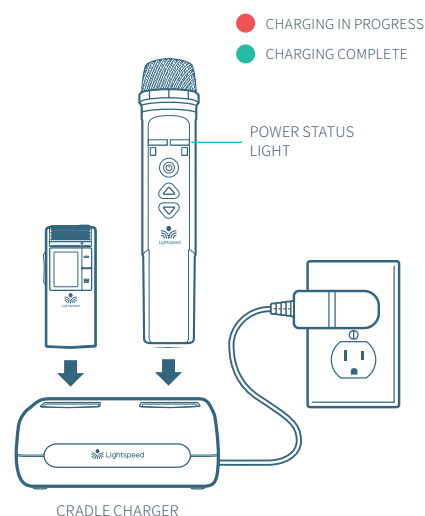

## CLEARMIKE OPERATION (default screen shown)

**NOTE:** Alert functions only available if integration is connected/enabled during setup.

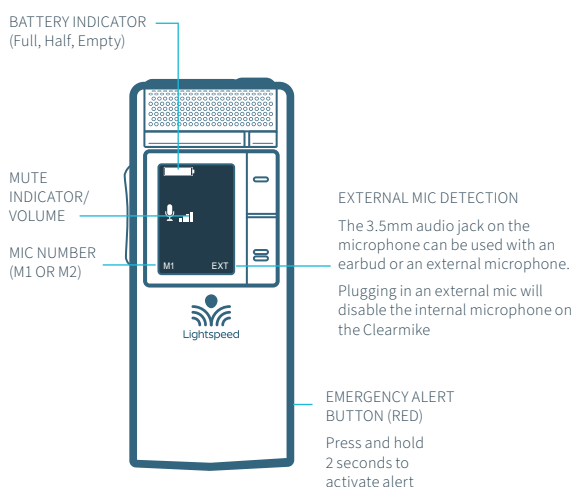

## USING A WIRELESS AUDIO LINK

You can connect your 2nd (or 3rd) microphone to your computer's USB port to enable a wireless 2-way audio link.

### SEND AUDIO FROM THE COMPUTER

to the T25 to ensure all audio from the computer (videos, video conferencing, audiobooks, music, etc) can be played through the Lightspeed T25 system and speakers.

**SEND AUDIO TO THE COMPUTER** from the T25 to ensure the teacher's FlexMike and any student microphones are clearly picked up by a video conferencing solution.

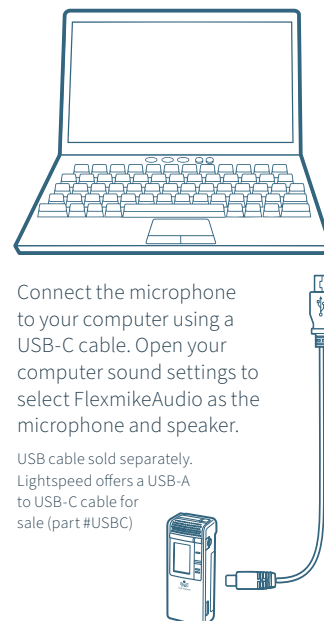

## PAIRING MICROPHONES TO THE T25



Your system is shipped with microphones and base units pre-paired for quick and easy use. If you ever need to pair new components, follow the pairing process below.

**PLEASE NOTE:** Microphones should be out of the charger while pairing.

### 1 POINT CLEARMIKE AT T25

From a powered off state, point the IR transmitter lens toward the T25.

### 2 PRESS AND HOLD CLEARMIKE POWER BUTTON

Press and hold the power button for 5 seconds until the Talk/Mute light starts flashing blue and white. The Power Status light on the T25 will also start flashing green and white.

### 3 CONFIRM STATUS

When complete, the Power Status light on the T25 will turn green, the Talk/Mute light on the microphone will be white, and the display on the microphone will say "Pair Success".

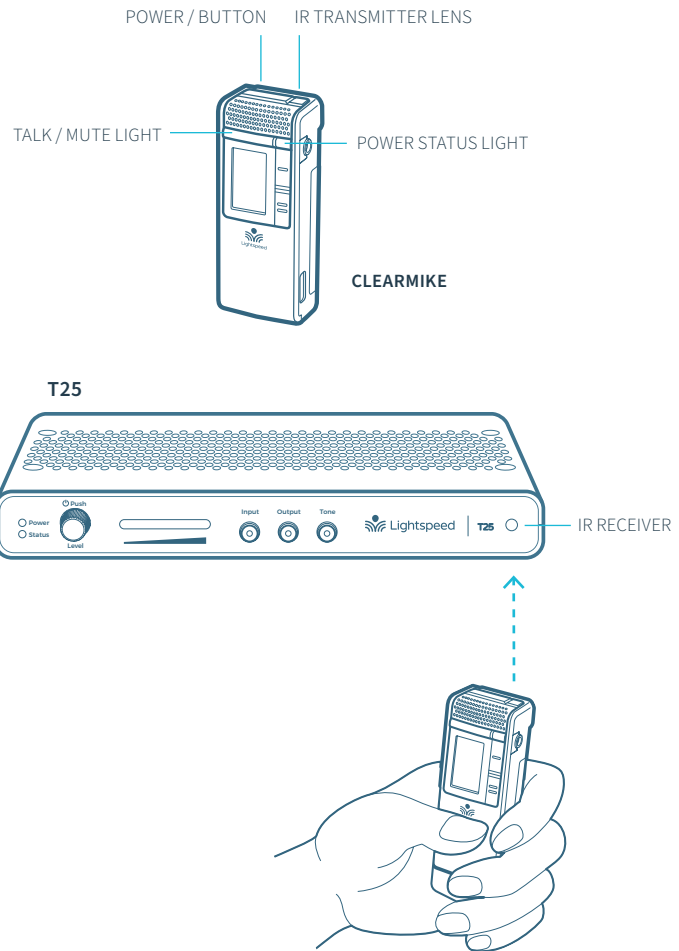

#### INSTALLATION GUIDE

For installation instructions, go to [www.lightspeed-tek.com/support/T25-installation-guide/](http://www.lightspeed-tek.com/support/T25-installation-guide/) (or scan the QR code).



#### USER MANUAL

For complete operating instructions, go to [www.lightspeed-tek.com/T25-usermanual](http://www.lightspeed-tek.com/T25-usermanual) (or scan the QR code).

